

CHANNEL VISION Limited Warranty

Channel Vision Technology will repair or replace any defect in material or workmanship which occurs during normal use of this product with new or rebuilt parts, free of charge in the USA, for two years from the date of original purchase. This is a no hassle warranty with no mail in warranty card needed. This warranty does not cover damages in shipment, failures caused by other products not supplied by Channel Vision Technology, or failures due to accident, misuse, abuse, or alteration of the equipment. This warranty is extended only to the original purchaser, and a purchase receipt, invoice, or other proof of original purchase date will be required before warranty repairs are provided.

Mail in service can be obtained during the warranty period by calling (800) 840-0288 toll free. A Return Authorization number must be obtained in advance and can be marked on the outside of the shipping carton.

This warranty gives you specific legal rights and you may have other rights (which vary from state to state). If a problem with this product develops during or after the warranty period, please contact Channel Vision Technology, your dealer or any factory-authorized service center.

500-102 rev A

CHANNEL VISION™

P-1420

6x4 Component Video Matrix Switcher

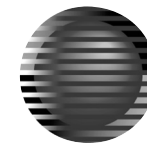

CHANNEL VISION™

234 Fischer Avenue • Costa Mesa, CA 92626
(714) 424-6500 • (800) 840-0288 • (714) 424-6510 fax
www.channelvision.com • email: sales @ channelvision.com

The **P-1420** is a 6x4 matrix switcher for HDTV video signals that allows 4 different displays to view any of the 6 different sources independently. It can be controlled via the front panel buttons, IR remote control, or RS-232 commands.

Features:

- RS-232 and IR control capabilities
- Audio & Component Video switched simultaneously
- Easy to read LED display

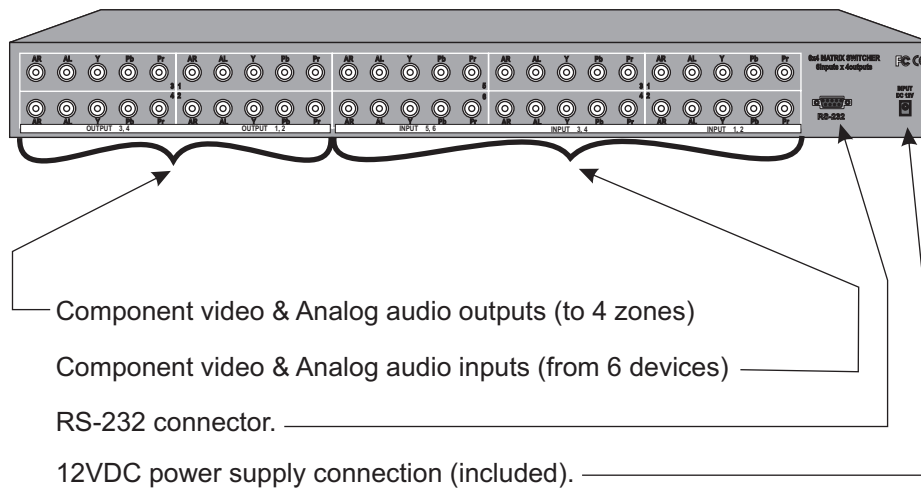
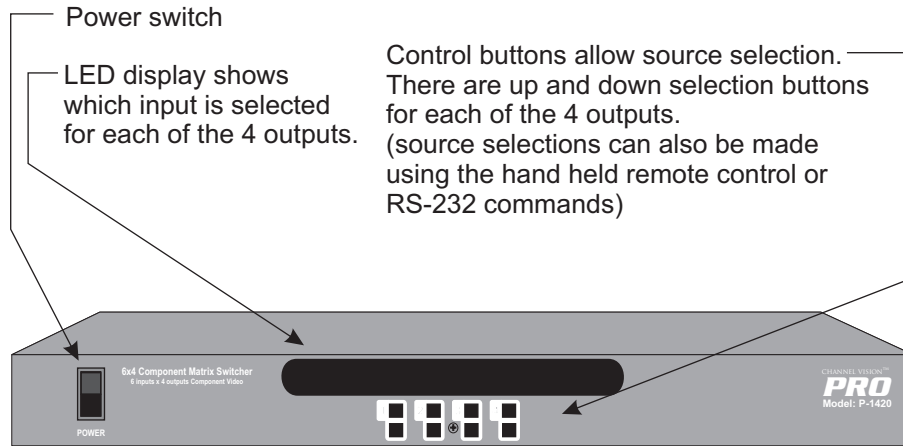

Specifications

Specifications: (typical)

Video Distortion:	<1.2dB (standard +/- 3dB)
Audio Distortion:	<0.6dB (standard +/- 3dB)
Channel Isolation:	>50dB
S/N Ratio:	>50dB
Video Crosstalk:	<60dB
Control Method:	RS-232 and hand held remote
Power Supply Voltage:	12 VDC
Power Consumption (max):	1.2A
Dimensions:	1.73"H x 17.37"W x 7.87"D
Net Weight (Unit Only)	5.83 lbs.

Specifications subject to change without notice.

Control Codes

Using the Remote:

The model P-0120 remote control comes with the P-1420 Matrix Switcher to allow easy source selection without having to use the buttons on the front the P-1420. The buttons are arranged in 4 columns and 6 rows. There is one column for each output and one row for each source. For example, to select source 6 to be output in zone 4, press the button in the lower right hand corner of the remote.

Using advanced control systems:

For installations that require more sophistication the P-1420 also supports RS-232 making it well suited for use with Creston, AMX, and other automation systems that support RS-232.

See RS-232 control information below.

RS-232 Control Code:

Baud Rate: 9600, No Parity, 8Bit Data, 1 Stop bit
Each transmission = 6bytes

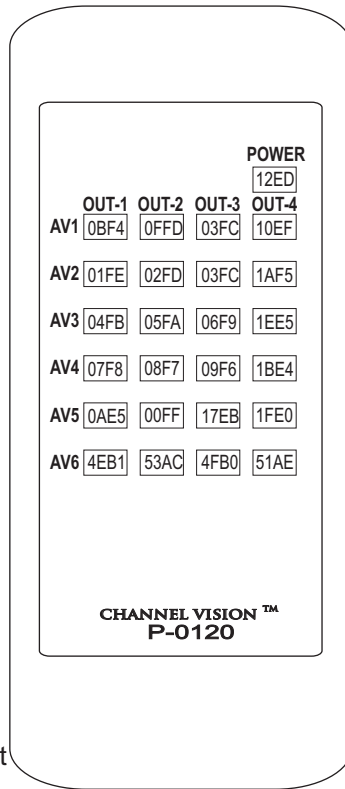

Control No.	Terminal 1	Terminal 2	Terminal 3	Terminal 4	Check Sum
86H	N	N	N	N	C
66H	N	N	N	N	C
76H	S	T	X	X	C
56H	S	T	X	X	C

Control No.:86H(Set Terminal), 66H(Ask Terminal Status),
76H(Set Power & Input), 56H(Ask Power & Input Status)

C:= (Control No. + Terminal(1)+Terminal(2) + Terminal(3) + Terminal(4))

Note: Invert the result and truncate the 8 least significant bits.

N: 31H~36H (31H is input 1, 32H is input 2, 33H is input 3, etc.)

S: 00H (Power off), FFH (Power On)

T: 00H (Enable Input), FFH (Disable Input)

What is a matrix switcher?

Simultaneous access to multiple sources is what differentiates a matrix switch from a simple switch which would only allow one source to be viewed by multiple zones. A matrix switcher allows multiple users to access signals from multiple source components. This type of switching is ideal for whole-house application. For example, it may be necessary to view the DVD player in the bedroom while, at the same time, viewing the satellite receiver in the home theater. The P-1420 is perfect for this application, as it allows 6 sources to be accessed by 4 different users simultaneously.

Included Accessories



P-0120 remote control ... The hand held remote can be used to control the P-1420 from the front of the unit or from another room through the use of an IR repeating system. The IR control codes can also be downloaded from www.channelvision.com.



Power Supply... 12VDC@1500 - 3000mA

How do the signals get to other rooms?

We suggest the use of a high quality video distribution system such as Channel Vision's P-1400 zero-loss video distribution system. This unit delivers flawless video signals over a 25 meter pre-made cable. The cable has been precisely constructed to match the pre-amplification provided by the P-1400. The cable must not be shortened or the benefits of the P-1400 will be negated.

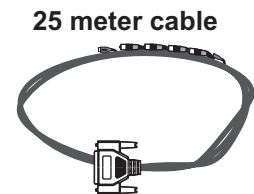
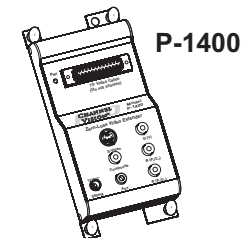

Connection Diagram

Make all connections before applying power.

