



PERFORMANCE MULTI-ROOM VIDEO

## Modulator Installation Manual



## Frequency-Agile Video Modulator

### Model 5515

This device complies with the FCC's Part 15 Rules for TV interface devices. Any change or modification to this device without the permission of Multiplex Technology, Inc. may void the user's authority to operate this equipment.

## Warranty

Multiplex Technology, Inc. warrants this product to be free from defects in materials and workmanship for a period of one year from the date of purchase or MTI will repair, or at its option, replace the defective product. To obtain warranty service, call MTI for a return material authorization (RMA) number and return the product prepaid to Multiplex Technology, Inc., 3001 Enterprise Street, Brea, CA 92821, Attention: Customer Service. Please put the RMA number on the outside of the carton.

Any implied warranty arising from the sale of the product including implied warranties of merchantability and fitness for purpose are limited to the warranty stated above. MTI shall not be responsible for losses or damages or expenses, whether direct, consequential or incidental arising from the use of or the inability to use this product. Some states do not allow limitations on how long the implied warranty lasts or the exclusion or limitation or incidental or consequential damages, so the above limitations and exclusions may not apply to you. This warranty gives you specific legal rights, and you may have other rights which may vary from state to state.



3001 Enterprise Street, Brea, CA 92821-6213, U.S.A.  
714-996-4100 \* 800-999-5225 \* FAX 714-996-4900 \* [www.channelplus.com](http://www.channelplus.com)



# Specifications: typical @ 25°C ± 5°C

## 5515 Modulator

<b>Inputs</b>	video	1 Vp-p @ 75Ω	
	audio	1 V rms @ 47kΩ	
		L & R inputs combined for monaural	
<b>Video performance</b>	differential gain	4%	
	differential phase	<4°	
	signal/noise	55 dB	
<b>RF output</b>	standard	UHF	CATV
	channel ranges	14-64	65-125 (excluding 95-99)
	output level	+25 dBmV (90dBuV)	
	IM distortion	-60 dBC	
	alternate channel	-45dBC @ 12MHz	
<b>Power supply</b>	model number	350-079	
	output current	600mA	
	output voltage	15 VDC	
	input voltage	105-125 VAC	
	power consumption	5 watts	
<b>Physical</b>	height	2.5 cm (1.0 in)	
	width	11.7 cm (4.6 in)	
	depth	8.1 cm (3.2 in)	
	weight	9.6 oz (0.273kg)	

## DECLARATION OF CONFORMITY

THIS DEVICE COMPLIES WITH PART 15 OF THE FCC RULES. OPERATION IS SUBJECT TO THE FOLLOWING TWO CONDITIONS: (1) THIS DEVICE MAY NOT CAUSE HARMFUL INTERFERENCE, AND (2) THIS DEVICE MUST ACCEPT ANY INTERFERENCE RECEIVED, INCLUDING INTERFERENCE THAT MAY CAUSE UNDESIRE OPERATION.

### Installation requirements:

FCC classifies this product under part 15 of its rules as a "television interface device".

Systems designed using television interface devices have the following legal requirements:

- 1) The modulated channel signal strength may not exceed 15.56dBmV at any television.  
*Federal Regulation 47CFR15.115(b)(1)(i).*
- 2) If an antenna is used in the system, the modulated channel signal strength may not exceed -51dBmV at the antenna input port. *Federal Regulation 47CFR15.115(c)(4).*

### For the Installer:

The system you design must comply with these regulations. As the installer, you are responsible. The easiest way to be fully compliant is to use a ChannelPlus coax panel. ChannelPlus panels have the necessary isolation from the modulator input ports to the antenna input port and gain characteristic from the modulator input ports to the television output ports. These features will make your modulator comply with the above requirements.

- 14) Protective Attachment Plug - The product is equipped with an attachment plug having overload protection. This is a safety feature. See Instruction Manual for replacement or resetting of protective device. If replacement of the plug is required, be sure the service technician has used a replacement-plug specified by the manufacturer that has the same overload protection as the original plug.
- 15) Outdoors Antenna Grounding - If an outside antenna or cable system is connected to the product, be sure the antenna or cable system is grounded so as to provide some protection against voltage surges and built-up static charges. Article 810 of the National Electrical Code, ANSI/NFPA 70, provides information with regard to proper grounding of the mast and supporting structure, grounding of the lead-in wire to an antenna discharge unit, size of grounding conductors, location of antenna-discharge unit, connection to grounding electrodes, and requirements for the grounding electrode. See figure A.
- 16) Lightning - For added protection for this product during a lightning storm, or when it is left unattended and unused for long periods of time, unplug it from the wall outlet and disconnect the antenna or cable system. This will prevent damage to the product due to lightning and power-line surges.
- 17) Power Lines -An outside antenna system should not be located in the vicinity of overhead power lines or other electric light or power circuits, or where it can fall into such power lines or circuits. When installing an outside antenna system, extreme care should be taken to keep from touching such power lines or circuits as contact with them might be fatal.
- 18) Overloading - Do not overload wall outlets, extension cords, or integral convenience receptacles as this can result in a risk of fire or electric shock.
- 19) Object and Liquid Entry - Never push objects of any kind into this product through openings as they may touch dangerous voltage points or short-out parts that could result in a fire or electric shock. Never spill liquid of any kind on the product.
- 20) Servicing - Do not attempt to service this product yourself as opening or removing covers may expose you to dangerous voltage or other hazards. Refer all servicing to qualified service personnel.
- 21) Damage Requiring Service - Unplug this product from the wall outlet and refer servicing to qualified service personnel under the following conditions:
  - a) When the power-supply cord or plug is damaged,
  - b) If liquid has been spilled, or objects have fallen into the product,
  - c) If the product has been exposed to rain or water,
  - d) If the product does not operate normally by following the operating instructions. Adjust only those controls that are covered by the operating instructions as an improper adjustment of other controls may result in damage and will often require extensive work by a qualified technician to restore the product to its normal operation,
  - e) If the product has been dropped or damaged in any way, and
  - f) When the product exhibits a distinct change in performance - this indicates a need for service.
- 22) Replacement Parts - When re placement parts are required, be sure the service technician has used replacement parts specified by the manufacturer or have the same characteristics as the original part. Unauthorized substitutions may result in fire, electric shock, or other hazards.

- 23) Safety Check - Upon completion of any service or repairs to this product, ask the service technician to perform safety checks to determine that the product is in proper operating condition.
- 24) Wall or Ceiling Mounting - The product should be mounted to a wall or ceiling only as recommended by the manufacturer.
- 25) Heat - The product should be situated away from heat sources such as radiators, heat registers, stoves, or other products (including amplifiers) that produce heat.

**Note to CATV system installer**

This reminder is provided to call the CATV system installer's attention to Section 820-40 of the NEC which provides guidelines for proper grounding and, in particular, specifies that the cable ground shall be connected to the grounding system of the building, as close to the point of cable entry as practical.

**POWER SUPPLY REPLACEMENT**

Replace defective power supplies only with parts specified by the manufacturer.

**Figure A**

Example of antenna grounding as per National Electrical Code, ANSI/NFPA 70

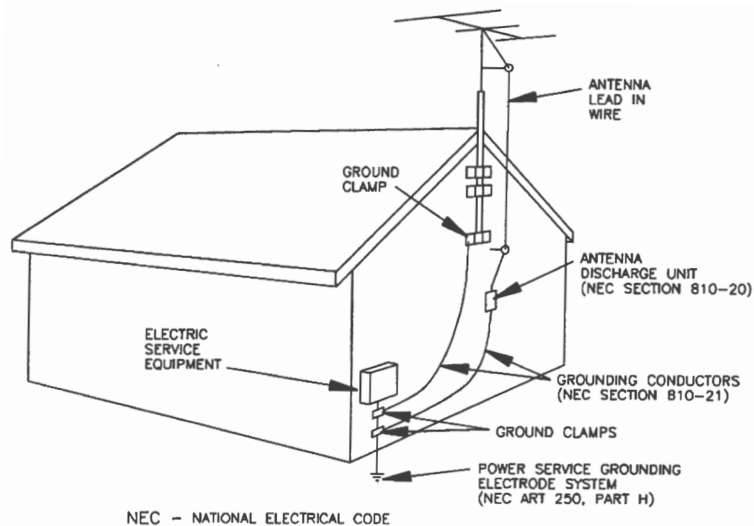

**Things to watch for:**

**No picture ...** Verify that the video source is on and is producing a video signal. Check that the TV and the modulator are tuned to the same channel. For example, if the modulator is broadcasting on UHF channel 16, make sure the TV is on UHF 16 rather than CATV 16. UHF 16 and CATV 16 are at different frequencies.

**Weak ChannelPlus UHF channel ...** If the TV has a separate UHF input, be sure that it is connected.

**Herringbone interference on ChannelPlus channel (diagonal lines) ...** You may have chosen a channel number that is not completely vacant. Distant UHF stations may be un-watchable, but will cause interference if you try to try to create a new channel at the same frequency. Also, cable companies often have extra signals where there should be none. Try moving the ChannelPlus channel to another number. You may have to add a low pass filter to remove cable company noise.

**Herringbone interference on many channels (disappears when you remove the modulator) ...** The high output of the ChannelPlus modulator can overdrive many RF amplifiers. Reduce the RF output using an attenuator. (ChannelPlus coax panels are designed to take the full output of these modulators.)

**Audio volume is low ...** The left and right audio inputs are combined for monaural. For proper audio level, both right and left inputs must be used. If you have a mono source, connect it to both right and left inputs using an RCA 'Y' connector.

**No color on ChannelPlus channels ...** You may have chosen the incorrect cable standard. Not all televisions can accommodate the 1.25MHz frequency difference between the H and I cable standards. See the section on programming.

**Changing modulation standards**

**Cable HRC and IRC considerations**

Most cable services use IRC frequency assignments. This is the default for the ChannelPlus 5500 series modulators. However, if the cable service uses HRC or the TV appears to search for the "house channels," the modulator can be reprogrammed to use HRC assignments by entering the number "98". Set to IRC by entering a "99". Both of these settings are only used for setting HRC/IRC.

**Valid Channels:** 14-64: UHF channels  
 65-125: CATV channels  
 95-99: not valid

**Channel Spacing:** Skip at least one number between channels.  
 Channels 14 and 16: OK.  
 Channels 14 and 15: Illegal.

**Error indication:** If an error has occurred or an incorrect channel is entered, the LED will flash quickly for a second and return to the previous settings.

**Channel number readback:** A readback mode will display the current channel assignments.

To readback modulator channel assignment  
 (example: modulator is programmed to channel **108**)

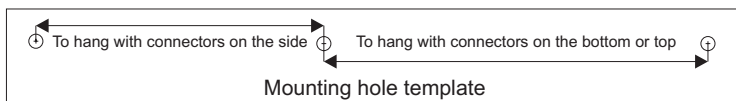
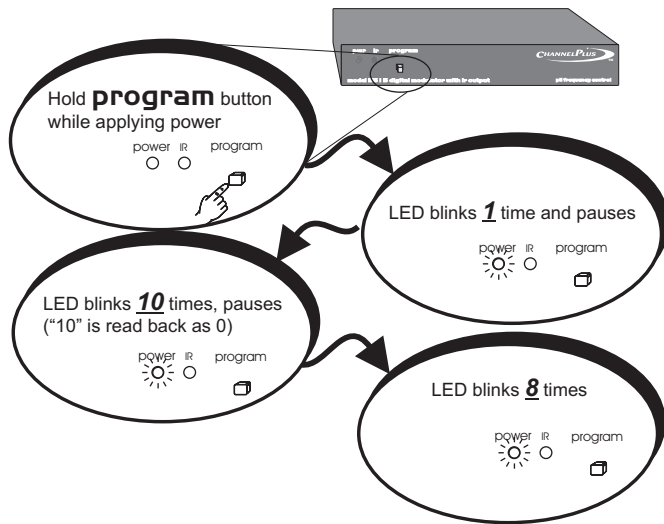

## Controls and Connections

The ChannelPlus 5500 Series are digitally-tuned video modulators that convert any baseband video and audio signal to a user-selected UHF, or Ultraband CATV. An internal quartz crystal reference oscillator and PLL circuitry ensure drift-free performance. The user selects the output frequency (channel) using the "program" button to enter the number of the desired channel. Any TV connected to the output via coax can receive the signals, when the TV is tuned to the proper channel.

### Model 5515 - Single channel agile modulator

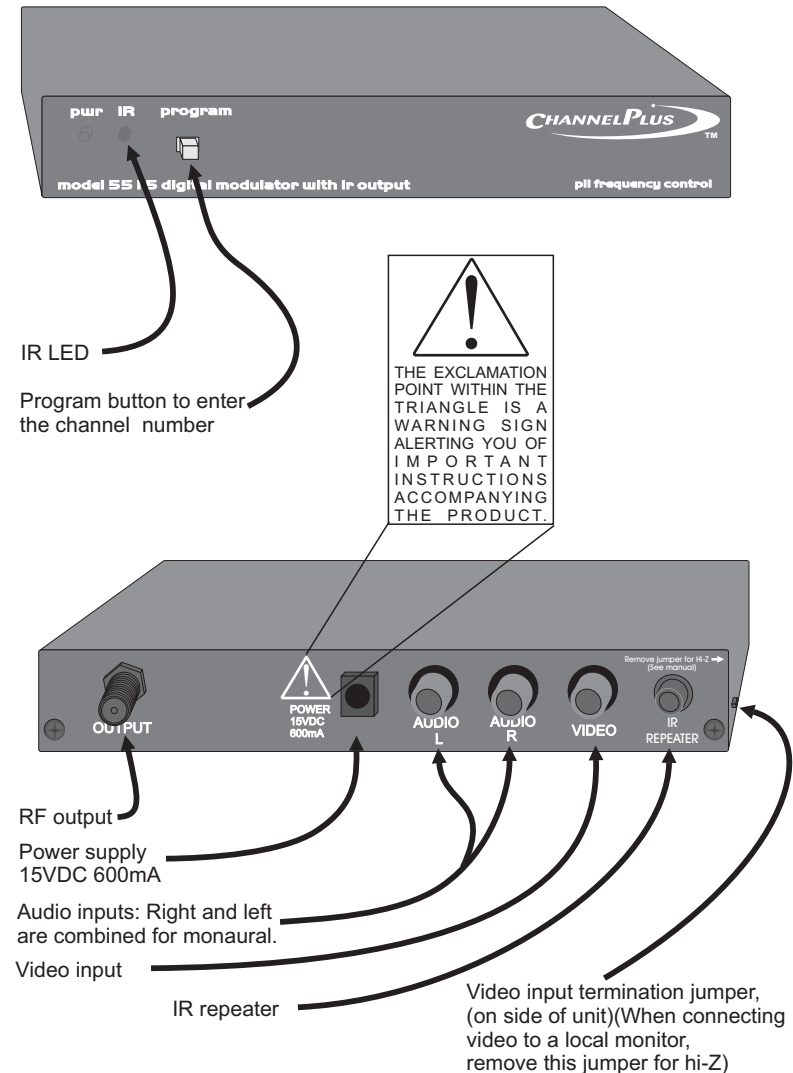

## Sample System Diagram

In this system, CATV or antenna channels are available on all TVs. In addition the following channel has been added:  
**Channel 70 - Satellite receiver**

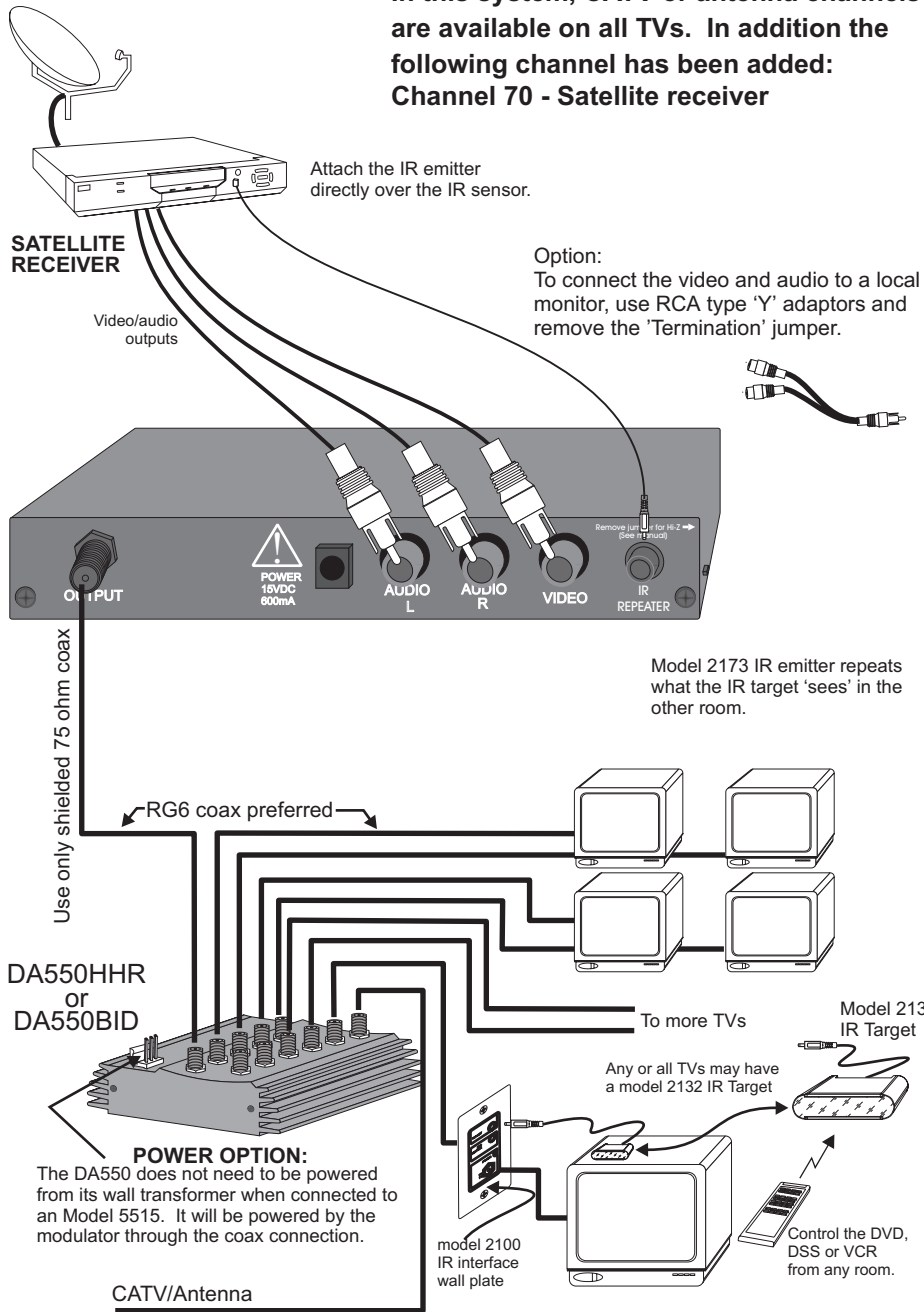

## Programming Examples:

To program modulator to channel **67**

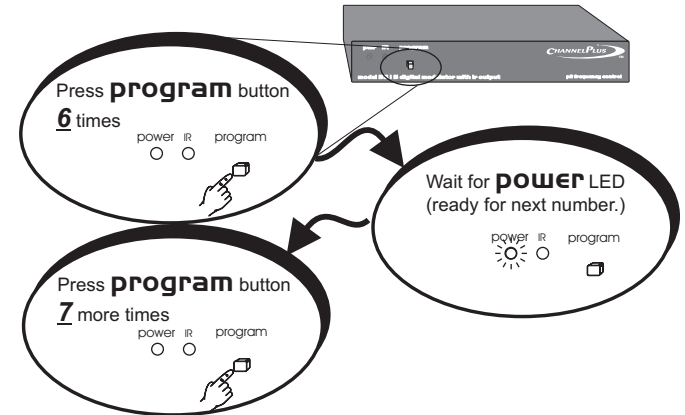

To program modulator to channel **120**

