

KidSmart™

Vocal Smoke Detector

Your Child, Your Voice™

Instruction Manual



***For questions concerning your
KidSmart™ Vocal Smoke Detector
call our customer hotline at
877- KIDSMART.***

Battery Operated

Model Number 10012VSD

Table of Contents

1. Quick Reference Guide	1
About the KidSmart™ Vocal Smoke Detector	1
Features and Benefits	2
Important Safety Operation	3
General Limitations	4
The Dangers of Fire	4
Different Types of Smoke Alarms	5
2. Programming Your Vocal Smoke Detector	6
Quick Programming Guide	6
What to Record in Your Vocal Smoke Detector	7
(How to awaken, calm and instruct with your personal message)	
3. Installing the KidSmart™ Vocal Smoke Detector	12
Where to Install This Alarm	12
How to Install Your Vocal Smoke Detector	15
4. Fire Drills and Practicing Your Escape Plan	17
Practice Fire Safety	17
Initiating a Fire Drill	17
Recommended Fire Drill Usage	18
Escape Plan	18
5. What To Do If The Alarm Sounds	19
6. Understanding the Indicator Lights & Horn Pattern	20
7. Maintaining Your Vocal Smoke Detector	21
8. Troubleshooting	24
9. Other Safety information	26
10. Warranty and Service Information	27

Product Registration

To register your five year warranty please complete and detach the Product Registration card, enclose it in an envelope and mail it to:

KidSmart Corporation
 8351 Roswell Road, Suite 382
 Atlanta, GA 30350, USA

You can also register online at www.kidsmartcorp.com.

This manual and the products described herein are copyrighted, with all rights reserved. Under these copyright laws, no part of this manual may be copied for use without the written consent of KidSmart Corporation. If you require further information, please contact our consumer hotline at 877-KIDSMART or write us at the above address. Our email address can be found at www.kidsmartcorp.com.

KidSmart™ Vocal Smoke Detector Product Registration

Name

Address

City State Zip

Phone Number

.....

Alarm Model Number (located on back of unit)

Date of Manufacture (located on back of unit)

Date of Purchase

Where Purchased

or distributors be liable for loss of use of this product or for any indirect, special, incidental or consequential damages or costs or expenses incurred by the purchaser, consumer or any other user of this product whether due to a breach of contract, negligence, strict liability in tort or otherwise, whether or not such damages, costs or expenses were foreseeable. KidSmart and its suppliers shall have no liability for any personal injury, property damage or any special, incidental, contingent or consequential damage of any kind resulting from gas leakage, fire or explosion.

KidSmart will not repair or replace any unit that has been damaged from neglect, abuse or failure to comply with any of the enclosed instructions.

Some states do not allow limitations of the duration of an implied warranty, additionally some states do not allow the exclusion or limitation of incidental or consequential damages. Therefore, the above limitations or exclusions may not apply to you. While this warranty gives you specific legal rights, you may also have other rights depending upon your place of residence.

Unless alterations to the above warranty are in writing and signed by both parties, no changes to the warranty will be recognized. The warranty may not be altered except in writing signed by both parties hereto.

Your KidSmart™ Vocal Smoke Detector is not a substitute for property, fire, disability, life or other insurance of any kind. Appropriate insurance coverage is your responsibility. Consult your insurance agent. Removal of the front cover will void warranty.

This alarm is not intended to alert the hearing impaired individual.

1. Quick Reference Guide

WARNING! These quick instructions and recommendations provide you with an overview of how to use your Vocal Smoke Detector. Read the user manual in its entirety before installing and using the KidSmart™ Vocal Smoke Detector.

About the Vocal Smoke Detector

The KidSmart™ Vocal Smoke Detector is a new smoke alarm system based on children's sleep and auditory patterns. Our system detects smoke, but uses an innovative method to inform the child of the fire. The KidSmart™ Vocal Smoke Detector supplements the high-pitched beeps of conventional detectors with spoken instructions recorded by parents or other caregivers.

Conventional smoke alarms have two serious limitations. First, although extremely loud, these alarms do not reliably awaken children; many children sleep right through the beeping. Second, if the child does wake up, these meaningless sounds give no instruction about what to do to escape the fire. Children do not naturally know what to do in these emergencies. Sometimes they attempt to hide under beds or in closets, which can have tragic consequences.

The KidSmart™ Vocal Smoke Detector's method of recording a parent's voice addresses both of these problems. Of course parents' rescue their children whenever possible, but when they can't get there, KidSmart™ provides the next best thing. The KidSmart™ Vocal Smoke Detector brings your voice to your child when he or she needs it the most.

There are over 400,000 home fires each year in the United States. Young children are at particularly high risk in home fires. In fact, each year more than 40,000 children under age 14 are seriously injured or killed in these residential fires. Fortunately, there is

something parents can do to help: Teach children what to do if a fire occurs in the home. Nothing is more effective at preventing injury in home fires than preparation and practice.

Features and Benefits

Familiar Voice

The KidSmart™ Vocal Smoke Detector is the only smoke detector that enables you to record a message using your own voice. Research studies from different independent testing authorities have shown that using a familiar voice dramatically increases the chances of awakening a child, compared to traditional smoke alarms. The child hears the familiar voice message and is less afraid and disoriented and is able to follow the recorded instructions to exit the household.

Drill Function

Rehearsing escape plans is a critical part of being able to effectively react in the event of a fire. Practice is vital to fire safety. Recorded messages are most effective when they remind children of instructions that have already been learned and practiced. Therefore, it is important to hold fire drills in which your children practice their evacuation procedure. The Vocal Smoke Detector is the only smoke detector on the market with a specific and conveniently located "Fire Drill" button that lets you practice fire drills with your children safely and easily.

Vocal Smoke Detector Horn and High Quality Speaker

The device alternates the standard smoke alarm horn and your familiar voice message. The high quality speaker plays back your recorded message at approximately 85db's at 8 feet or more depending upon the recording level of your original message. The horn meets all UL and ULC standards for audible horn (US and Canada.)

11. Warranty and Service Information

Limited Warranty

KidSmart warrants to the consumer that purchases the product that the enclosed alarm (excluding the batteries) will be free of defects in material or workmanship, if used as directed for a period of five years from the date of purchase. The obligation of KidSmart under this warranty is limited to repairing or replacing the alarm or any part which we find to be defective in material or workmanship, free of charge. Send the alarm with proof of date of purchase, postage and prepaid return postage to:

Warranty Service Department
KidSmart Corporation
8351 Roswell Road, Suite 382
Atlanta, GA 30350, USA

Please include your name, address, and phone number along with a brief description of what is wrong with the unit. For further assistance please call our toll free Consumer Hotline at 877-KIDSMART.

KidSmart makes no warranty, express, implied, written or oral, including that of merchantability of fitness for any particular purpose, with respect to the batteries.

This warranty is void if the alarm has been damaged, modified, abused or altered after the date of purchase or if it fails to operate due to improper installation, maintenance or inadequate DC power, or used in any way other than pursuit to the enclosed instructions. Any implied warranties arising out of this sale, including but not limited to the implied warranties of description, merchantability and fitness for a particular purpose, are limited in duration to the above warranty period. In no event shall KidSmart and its suppliers

10. Additional Safety Information

Fire Prevention

Never smoke in bed, or leave cooking food unattended. Warn children of the danger in playing with matches or lighters. Everyone in the home should recognize the voice message warnings and know to leave the home using the previously determined escape plan.

Learn how to Stop, Drop and Roll if clothes catch on fire, and how to crawl low under smoke.

You should teach everybody in the household to touch the door before opening it. If the door is hot teach them NOT TO OPEN the door and consider an alternate escape route. If the door is not hot, they should exit the house through the door with caution, and utilize hallways and staircases if possible. You should also teach them to crawl along the floor to stay below dangerous smoke, fumes and gases.

Install and maintain fire extinguishers on every level of the home including the basement. Additionally, extinguishers should be installed in the kitchen, and garage. Learn how to use a fire extinguisher prior to an emergency. Second levels and higher occupied rooms with windows should have escape ladders.

Indicator Lights

The Vocal Smoke Detector is equipped with a bright light ring that illuminates during drills and in case of an alarm.

Low Battery Warning

The device checks its battery level automatically on a regular basis. If the battery level falls below a critical level, the device will emit a chirping sound once every minute to indicate a low battery status. Batteries should be replaced as soon as the chirping begins.

Self-Testing Function

The device checks to make sure the batteries and smoke sensor are fully functional by performing a self-test. The self-test is indicated by a brief red flash of the light ring around the "drill" button. The self-test occurs once every forty seconds.

Weekly Test Function

The device should be checked weekly for proper operation. By pressing the fire drill button briefly once, the device will run a self test. Upon successful completion of this self testing procedure, the device will beep three times and playback your recorded message.

Important Safety Information

Because smoke in one area may not reach a smoke alarm in another, smoke alarms are recommended in every room and on every level of the home. Interconnected alarms can provide better whole-home protection than stand-alone alarms. This alarm is designed to be used in ordinary indoor locations of single-family households only. The sensitivity of the smoke sensors, the horn patterns and the speaker sound level comply with UL/ULC standards.

General Limitations

This alarm, like ALL alarms has limitations. It is not foolproof and is intended to contribute to but not warranted to protect lives or property. This alarm should not be considered as a substitute for insurance.

Smoke alarms do not sense heat, flame, or gas; they only activate when smoke reaches their sensors. In some cases, smoke may not activate the sensors QUICKLY ENOUGH to ensure safe escape. Smoke alarms do not prevent or extinguish fires.

If the alarm is poorly positioned, obstructed, and/or competing with ambient noise, the probability of successfully alerting every household member decreases. The condition of the residents may also affect the effectiveness of the alarm; it is not intended to alert residents who are hard of hearing.

It is possible for the alarm to fail at any time. You must test the alarm weekly and replace it every 5 years.

The Dangers of Fire

Fire is unpredictable and dangerous. It can elevate air temperatures at eye-level to over 1200°F (650°C), and completely destroy a multi-level home in minutes! A fire can rapidly engulf a house in flames or smolder slowly for hours depending on the source, environmental conditions, and objects within the home. A typical fire allows residents only minutes to get to safety, so it is important to have adequate alarms within the home. Each level should have at least one alarm, with additional alarms in each bedroom.

The Vocal Smoke Detector does not attach back onto the mounting plate.

- * Check that all batteries are present in the battery compartment. The device is designed so that it cannot be attached to the mounting plate in the absence of batteries. Replace batteries.

The Vocal Smoke Detector chirps once every minute.

- * This indicates a low battery condition. Replace all batteries with recommended batteries. (Duracell MN1500, MX1500 or Energizer E91.)

Alarm sounds but no hazard is present.

- * Take Emergency Safety Actions in all alarm situations! If no hazard proves to be present, test the alarm to check for proper functioning by pushing the drill function button once. Clean the alarm. (See Chapter 7 - CLEANING.) Check that the alarm is placed properly. (See Chapter 3 - WHERE TO INSTALL THIS ALARM.)

9. Troubleshooting

Alarm does not sound and lights do not flash when unit(s) is tested.

- * Make sure the yellow pull out battery tab has been removed prior to installation. If it is still in place, pull this tab out and record your own personalized message.
- * If the problem still persists, replace all 4 batteries at once with brand new batteries. Make sure you insert the batteries as recommended on the diagram shown at the bottom of the battery compartment. Test the unit again by pushing the drill button once.
- * If the problem still persists, contact the appropriate source for service or replacement.

The alarm horn works but you can not hear the message playback during the drill function.

- * Detach the unit from its mounting plate by twisting it counter clockwise.
- * Push the Record/Play button once. If you don't hear anything but the light turns on around the drill function button, re-record your own personal message and test the unit again. If the problem persists contact the appropriate source for service or replacement.

Different Types of Smoke Alarms

Photoelectric smoke alarms, such as this alarm, excel in detecting slow, smoldering fires which produce a substantial amount of smoke before bursting into flame. These fires are often the result of burning cigarettes left unattended near flammable objects.

Ionization smoke alarms generally detect high combustion, flaming fires which spread quickly. Paper burning within a trash can, and grease fires in kitchens are potential sources of such high intensity fires.

NOTE - This alarm uses only a photoelectric type detector for sensing smoke. You may wish to consider installing other ionization alarms or combination ionization/photoelectric dual sensor alarms in your home for increased protection.

2. Programming Your Vocal Smoke Detector

Quick Programming Guide

The Vocal Smoke Detector must be programmed PRIOR to mounting. Failure to comply with this recommendation will transform your Vocal Smoke Detector into a regular smoke alarm with a loud horn alarm and no customized message.

Engaging the Batteries

1. Remove the mounting bracket from the unit.
2. Remove the yellow Battery Pull Tab from the back of the unit. Removing the tab will engage the batteries to power the unit.
3. Turn the unit over and make sure a red light is briefly flashing once every 40 seconds. The red light indicates your unit is now battery powered and you are ready to record your personal message.

Recording Your Message

(refer to next section for effective message examples)

1. Turn over the unit.
You will see a MIC at the top of the unit and a button on the bottom that says Record/Play.
2. To record your message, press and hold the "RECORD/Play" button and speak very loudly and seriously into MIC after the beep.
3. To end recording, release the "RECORD/Play" button.

Repair

CAUTION! Do not attempt to repair this alarm. Doing so will void your warranty.

If the alarm is not operating properly, see "Troubleshooting."

If necessary and if still under warranty, return the alarm to KidSmart Corporation as described in the Warranty and Service Information section of this instruction manual.

Battery Replacement

Replace the batteries at least once a year or immediately when the low battery chirp sounds. This unit uses only alkaline AA batteries. Duracell MN1500, MX1500 or Energizer E91.

IMPORTANT: DO NOT USE ANY OTHER TYPE OF BATTERIES, EXCEPT THOSE SPECIFIED IN THIS MANUAL. DO NOT USE RECHARGEABLE BATTERIES.

TO REPLACE THE BATTERIES:

1. Remove unit from mounting bracket by turning it counterclockwise.
2. Turn unit over to expose battery door.
3. Push tab to release battery door and remove drained batteries from compartment and discard.
4. Install fresh alkaline AA batteries from the list of correct batteries listed in this manual.
5. Close battery door.
6. Turn over unit and check to see the unit is functioning. The red ring will briefly flash once every forty seconds.

IMPORTANT: If red light does not blink, check batteries and connection. If problem persists, check "Trouble Shooting" chapter.

CAUTION: Never leave the battery door open to silence a Low Battery Warning. Replace the batteries and close the battery door after the batteries are replaced.

4. The unit will automatically play back your message to check its sound level. A flashing green light indicates that the message has been saved. A flashing red light indicates that the message needs to be recorded again.
5. To listen to your message again, press "RECORD/Play" button once.

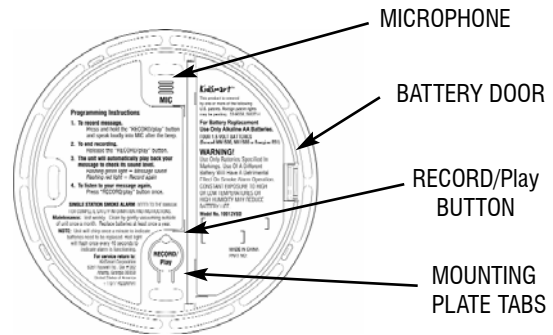

What to Record in the KidSmart™ Vocal Smoke Detector

Recorded messages in Vocal Smoke Detectors have three goals:

1. Awakening the child
2. Calming the child
3. Instructing the child

The strength of the KidSmart™ system is that it allows parents to customize their messages for each individual child. This manual will explain how to create an effective script, as well as offer examples. Because the optimal script depends on the layout of the home and the capabilities of each child, the developers of the KidSmart™ Vocal Smoke Detector hope to collaborate with parents using their familiar voice message to create the best possible instructions for each family.

Awakening the Child

This first step sounds simple, but it can be more difficult than it seems. Children are very sound sleepers and can sleep through extremely loud sounds, as evidenced by the frequent failure of conventional smoke alarms in awakening children. Fortunately, research has discovered one type of sound that is more effective than any other at awakening people: the sound of the person's own name. (Psychological research on the "cocktail party effect" has demonstrated this special responsiveness of the human hearing system to the sound of one's own name.)

The KidSmart™ system capitalizes on this responsiveness by enabling parents to record a message that includes their child's name. (Generic recordings do not have this capability and are less effective.) Parents should begin their message with the child's name and say the name at least twice in the message.

Calming the Child

The possibility of panic is a significant danger in fire emergencies, because children who are overwhelmed by fear might fail to take effective action for escape. The KidSmart™ system has significant calming capability, because the sound of a parent's voice is reassuring to most children. In addition, it is helpful for the recorded message to include a brief statement designed to encourage the child and reduce the danger of panic. This part of the message should simply state that the child will be okay, and he or she should listen to the instructions and do what they say.

Instructing the Child

Evacuation instructions are the part of the recorded message requiring the most thought and planning from parents. Usually, this will be the longest part of the recording. We want to provide children with an optimal amount of information – not too little and

8. Maintaining Your Vocal Smoke Detector

To keep your Vocal Smoke Detector in good working order, please follow the simple steps below:

Testing

Verify the unit is functioning properly by pushing the "Hold to Drill" button once a week or upon returning from vacation or when no one has been in the household for several days. The unit will run through the alarm sequence ONCE. The alarm sequence is as follows: The red ring will flash and the unit will emit the tonal alarm message at 85db for four seconds, followed by the personal message.

Cleaning

To ensure proper functionality, remove dust, dirt, or debris build-up at least once a month. Remove the unit from the mounting bracket and using the soft brush or wand attachment to a vacuum cleaner, vacuum all sides and cover of the alarm. Be sure all the vents are free of debris before reinstalling the unit. **REINSTALL IMMEDIATELY AND THEN TEST THE UNIT BY PRESSING THE "HOLD TO DRILL BUTTON."**

IMPORTANT: Do not remove the cover or clean inside the smoke alarm. Do not use abrasive cleansers or spray the alarm with cleaning agents or waxes, especially those cleaners containing ammonia. These liquids may impair the performance of sensors, and prevent the alarm from alerting you to a fire. Do not submerge the alarm in water. Avoid using air fresheners, hair spray or other aerosols near the unit. Do not paint the unit. Paint will seal the vents and interfere with the sensor's ability to detect smoke.

6. Understanding the Indicator Lights & Horn Patterns

Indicator Lights

Red LED flashes every 40 seconds - Unit is functioning properly and is checking for hazardous smoke and battery life. With an AC/DC model, the unit is also monitoring the interconnect for signals from other smoke and heat alarms.

Red LED flashing constantly - Device senses smoke. Alarm and personal message will sound.

Green LED (*back of unit*) - Indicates user is recording message or playing back a successfully recorded message.

Red LED (*back of unit*) - Personal message has been incorrectly recorded.

Horn Patterns

Unit chirps once a minute - Low Battery Warning. Batteries need to be changed. The unit will still be fully functioning for seven days. After seven days, the unit will chirp until the batteries die .

Alarm Function - Unit flashes red light, emits 85dbs alarm for 4 seconds followed by personal wake-up message. This sequence will run continuously until the alarm condition returns to normal. There is no way of disengaging the alarm, once the unit has sensed smoke, unless the unit is moved to fresh air or batteries are removed.

Drill Function - After the drill button is depressed, unit will delay five seconds before going into the alarm sequence for 3 minutes. User can disengage the drill function by pressing the "Hold to Drill" button once.

not too much. Parents should be careful not to include excessive information in the message, because this type of overload can confuse children and prevent them from understanding any information at all. It is important to remember the conditions under which your child will hear the message: He or she will be awakened in the middle of the night and will need to respond quickly to an emergency. Given the effects of sleep and the importance of quick action, it is best to make your message as simple and clear as possible, so your child will be able to make use of the instructions you record.

The complexity of recorded instructions should be appropriate to the child's cognitive level, which usually corresponds to the child's age. Young children should receive very simple messages. Older children and adolescents should receive more complex instructions.

One issue related to complexity is whether or not the instructions should include contingency plans. In fire emergencies, contingency planning means stating more than one possible response to the fire and identifying which option to use in different situations.

Parents should decide whether or not to include contingency planning in their message based on their assessment of the child's ability to make use of this complex type of information. Contingency planning is appropriate for most children above age seven years. However, young children are not generally capable of responding competently to complex instructions of this type.

Therefore, instructions for children below age seven generally should not include contingency planning. (Children aged 6-7 years are in the gray area, and parents of these children should decide whether to include contingency planning based on their assessment of the child's abilities.)

Instructions for young children. Recorded directions for young children should state only the basics of what the child should do in the event of a fire emergency. There should be three basic directions: (1) wake up, (2) leave the home, and (3) meet at a specified place (do not re-enter the home.)

Parents should use a tone of voice that communicates a sense of seriousness and urgency. This tone should strike a balance: You do not want to panic your children by sounding hysterical, but it is important to convey that you mean business in these recorded messages.

The KidSmart™ system provides 15 seconds of recording time for your familiar voice message. This is not a long time; therefore, it is important to choose your words carefully.

The device will repeat the message a number of times. With these points in mind, here is an example of a script appropriate for young children:

“ _____ (child’s name) wake up! Its Mommy, there is a fire in the house. You’ll be okay, remember what we practiced _____ (child’s name.) Get out of your room, down the stairs and out the door; meet me by the tree in the front yard.”

Instructions for older children. These directions can be more complicated and can involve contingency planning; the recordings can tell children different things to do in different situations. For example, messages can remind the child of two possible escape routes from the home, so that if the first route is blocked by the fire, the child has an alternate way to go.

5. What To Do In Case The Alarm Sounds

WARNING: THE SOUND OF THE ALARM HORN OR VOICE PLAYBACK REQUIRES YOUR IMMEDIATE ATTENTION AND ACTION. DO NOT IGNORE THE ALARM! TAKE EMERGENCY ACTION IMMEDIATELY!

DO NOT disconnect battery to silence the alarm as this may seriously compromise your safety.

***Assess the situation around you and take appropriate action.
Check first for fire.***

In Case of Fire

Exit the household immediately by following the safest of your escape plans depending on the area of danger. Do not stop to pick up anything along the way. You can tell if a door is safe to open by touching it with the back of your hand. If it is hot, consider an alternate escape route. If it isn’t hot, open the door slowly and be prepared to close it if you sense heat or smoke.

- * Crawl low if you have to go through areas with heavy smoke.
- * Stop, Drop and Roll if any of your clothes catch on fire.
- * Meet other members of the household in the predefined location outside.
- * Make certain all persons are accounted for.
- * Call 911 from outside the house as soon as possible.
- * Never consider re-entering the household without proper authorization from the fire department representative.

Low Battery Alarm

If the battery level runs low, the unit will chirp once every minute. Replace all 4 AA batteries immediately. Follow instructions at the bottom of the battery compartment for sequence of installation. The unit will not work and cannot be placed back on its mounting plate without batteries. If you do not replace the batteries, this low battery warning will continue for at least 7 days, while still fully functioning. After 7 days, the unit will chirp until the batteries die.

The delay should last about 5 seconds before the Vocal Smoke Detector starts the fire drill. The fire drill will run for about 3 minutes. If you wish to end the fire drill sooner, just push the fire drill button once and the device will terminate the drill exercise.

Recommended Fire Drill Usage

There should be a fire drill soon after the initial evacuation training and then again about one month later, so the new learning is established in the child's memory. After that, home fire drills should be held about once every six months. One way to remember the timing of these drills is to do them whenever you change your clocks, whether moving them forward in the spring or setting clocks back in the fall. These fire drills take a little bit of time, but they will greatly increase your children's safety in the event of a fire – and your children are worth it!

Escape Plan

It is important to carefully prepare an escape plan prior to needing it. Plans should include at least two different ways out of every room, door, and window; as mentioned before fire is unpredictable and could prevent the use of one or more exit strategies. Identify a meeting place outside of the house so you know when everyone is safe. Call the fire department from OUTSIDE the building and wait for them to arrive. Never go back into a burning building.

One important contingency in a fire involves a choice between three options: (1) leaving the home by walking or crawling out, (2) leaving by climbing out a window, and (3) staying in place and waiting for rescue, rather than attempting to leave. Most of the time, the best thing to do is option #1, walking or crawling out of the home. However, sometimes the fire outside the child's room is so severe that escape routes are blocked. The way to tell whether this is the case is to touch the door; if it is hot to the touch, the door should not be opened, and the child should not leave the room. If the door is not hot, the child should walk or crawl out of the home.

If the option of walking out is not possible, there are two other options. Sometimes children can escape through a window, perhaps by going down a fire escape or using a ladder. If this cannot be done, the remaining option is to stay in place and wait for rescue by firefighters or parents. If possible, children should seal openings around the door and open the window to let air in.

Fires sometimes produce thick, hazardous smoke that can be difficult or even impossible to walk through. The most effective response to this problem is to get close to the floor, where the air is better (because smoke rises), and to move by crawling, not walking. The example below, which is appropriate for older children, takes the above possibilities into consideration:

“ _____ (child's name) wake up! It's Daddy.
There is a fire in the house. You'll be okay, remember what we practiced _____ (child's name.) Touch the door. If it's not hot, open it, and meet us in the front yard. Remember to crawl if it's smoky. If the door is hot, don't open it. Climb out the window.”

3. Installing the KidSmart™ Vocal Smoke Detector

Where to Install This Alarm

Optimally, Vocal Smoke Detectors should be installed in each child's bedroom. With this arrangement, the alarm signal should be loud enough to awaken the child, and parents will be able to tailor their recorded messages for the location of each room and the personality of each child.

If it is not possible to have a detector in each room, one should be installed on each floor of the home. This is a minimum requirement for fire safety. The detector should be placed just inside each bedroom's door with the speaker aimed directly at the child's bed.

IMPORTANT! The following are general guidelines to assist you in optimizing the location(s) of your alarm installation.

Recommended Number of Alarms

Fire safety professionals recommend that each room of your house be equipped with a smoke alarm. For minimum protection, you should have a smoke alarm centrally located on each level of your home *AND* a smoke alarm in each bedroom and sleeping area.

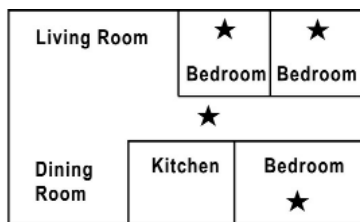

4. Fire Drills and Practicing Your Escape Plan

Practice Fire Safety

Practice is vital to fire safety. Recorded messages are most effective when they remind children of instructions that have already been learned and practiced. Therefore, it is important to hold fire drills in which your children practice their evacuation procedure. To prevent these drills from frightening the children, explain that your safety measures will keep everyone safe if a fire occurs.

There are three steps to training your children to respond to a home fire. First, let them listen to the recorded instructions you make with the KidSmart™ Vocal Smoke Detector, so they will not be confused by hearing your voice without your physical presence. Then, have your children perform the evacuation instructions several times, so they know exactly what to do and can do it quickly and automatically. Finally, hold occasional fire drills at night. You should tell your children about the drills in advance, so they are not frightened when awakened by the smoke detector.

Initiating a Fire Drill

Initiating a fire drill is easy. When the Vocal Smoke Detector is mounted on the ceiling you will be able to access the fire drill button.

In order to initiate the fire drill you should push and hold the button down for about 2 seconds until the light ring lights up red. The light ring will flash several times at regular intervals indicating that a delayed initiation of the fire drill has been activated. If you used a chair or a step ladder be careful and don't rush coming down as you might risk serious injuries if you fall.

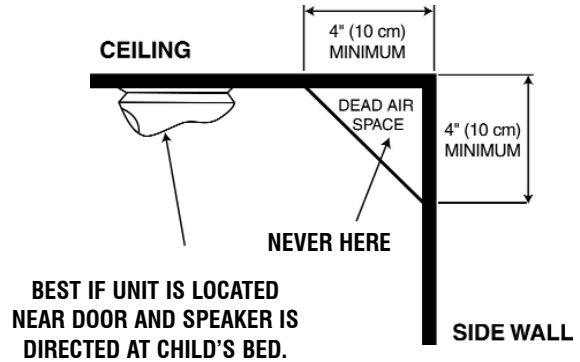
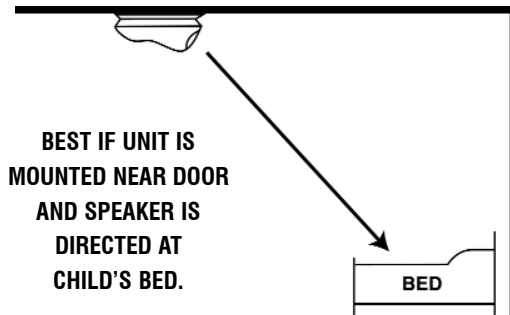

2. Use a 3/16" (5mm) drill bit to drill through the center of the outlines you made in Step 1.
3. Insert screw anchors into the drilled holes. The anchors should be flush with the mounting surface.
4. Attach the mounting plate to the desired surface with the mounting screws provided. Before tightening down the screws verify that the molded-in arrows are pointing in the right direction, if not adjust the direction and tighten down the screws.
5. Position the Vocal Smoke Detector on the mounting plate and turn clockwise until the unit locks into place.
6. Press the "Hold to Drill" button once briefly to test the Vocal Smoke Detector to ensure the unit operates properly. The device will beep three times and play your personal message back to you.

This alarm, like all alarms, sounds only after smoke reaches its sensors. Environmental obstructions can prevent the alarm from activating, and alerting you to danger. Install the alarm where it will be free of special barriers and ambient noise. Experiment with your installation choice to assure the alert can be heard in various rooms within the house.

Avoid Installing Smoke Alarms in the Following Locations:

- Near areas or appliances with high humidity. (i.e. bathrooms, dishwashers, or washing machines.) Install at least 10 feet (3 meters) away from these areas.
- Near areas or appliances where normal combustion regularly occurs (i.e. kitchens, furnaces, or hot water heaters.)
- Within 3 feet (1 meter) of heating and cooling vents, or air returns. The air could blow smoke away from the detector's sensor and prevent an alarm from sounding.
- In extremely dusty, dirty, or insect infested areas.

- In rooms that experience temperatures below 40°F (4°C) or above 100°F (38°C.)
- Within 3 feet (1 meter) of fluorescent lighting.
Electrical noise can unnecessarily activate an alarm.

Check Your Local Building Codes

This smoke alarm is intended to be used in single-family homes. It may not meet requirements for multiple-resident dwellings such as apartment buildings, boarding homes, hotels, or motels. Some codes require that smoke alarms be interconnected in new construction.

The National Fire Protection Association

The minimum NFPA residential requirement states that each level of the house be equipped with a smoke detector and that detectors should be installed directly outside of each separate sleeping area. NFPA recommends that for new installations a smoke detector should be installed in each sleeping room as well as the basement, dining room, hallways, attics, furnace room, closets, utility and storage rooms and garages.

California State Fire Marshal

The California State Fire Marshal recommends installing smoke detectors in all rooms and areas of the household, especially in each sleeping area. Smoke or heat detectors should be installed in living rooms, dining rooms, bedrooms, kitchens, hallways, attics, furnace rooms, closets, utility and storage rooms, basements and attached garages. KidSmart Corporation recommends that you place one KidSmart™Vocal Smoke Detector in each of your children’s bedrooms for best response in case of a fire.

How to Install Your KidSmart™ Vocal Smoke Detector

IMPORTANT - *Prior to installation, you should remove the mounting bracket and battery pull tab and record your message. Make sure your unit is working by turning it over and making sure the red ring around the “Hold to Drill” button flashes red once every 40 seconds. Press the “Record/Play” button on the back once to check your recorded message.*

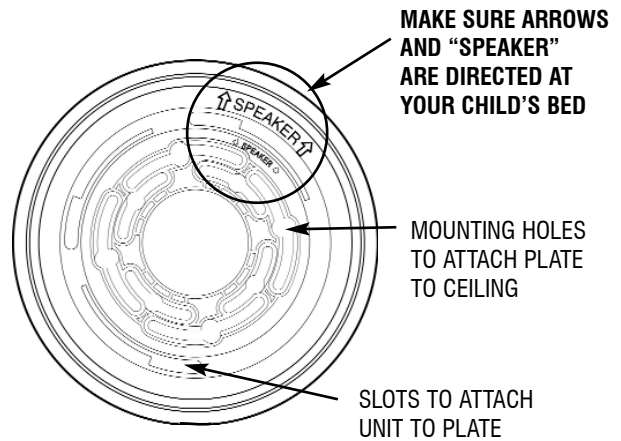

1. Hold the mounting plate against the ceiling (flat side against the surface) in the desired position and use a pencil to trace the inside of the mounting slots. See Diagram. The mounting plate has graphics arrows molded in; you should orient the mounting plate so that the arrows are pointing toward the head of the child’s bed. See Diagram. If you are installing one Vocal Smoke Detector in a room with multiple beds, the arrows should be pointing in a direction that will provide all beds with the best sound output possible.